

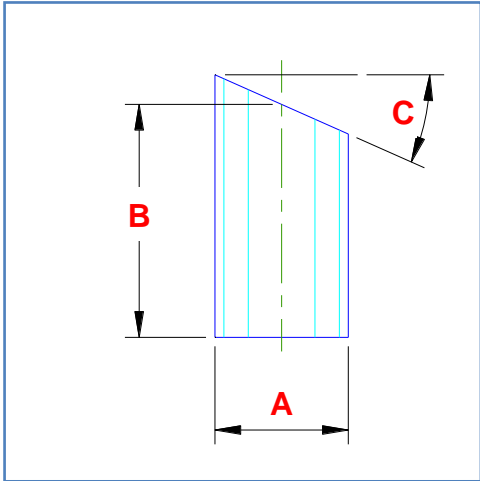



Client Name:		Contact Phone:
Date:	This item ID:	References PO No:
Authorised by:		Signature:
<b>Purchase order to show quantities and date required. PO to reference This Item ID</b>		

<p><b>Right Cylinder - Top Truncated</b></p> <p>A right cylinder. The top of the cylinder is truncated at an angle to the base. The height is measured at the center-line of the cylinder..</p>	
---	---



Dimension	Description	Your dimension
<b>A</b>	<i>Base Diameter</i>	
<b>B</b>	<i>Height (at center line)</i>	
<b>C</b>	<i>Cutting plane angle</i>	

<b>Units of measure (mm, m, inch, etc):</b>				
<b>My dimensions are measured at the (tick one) :</b>		<b>Inside</b> 	<b>Mean</b> 	<b>Outside</b> 
<b>Material Type:</b>		<b>Material Thickness:</b>		

**ALL information in this document must be completed to produce a pattern.**  
For further information contact details are at [www.plate-n-sheet.com.au](http://www.plate-n-sheet.com.au).

Client Name:		Contact Phone:
Date:	This item ID:	References PO No:
Authorised by:		Signature:
<b>Purchase order to show quantities and date required. PO to reference This Item ID</b>		

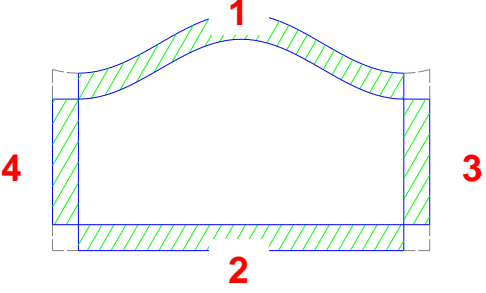
<b>Lap Details</b>				
Are overlap allowances to be added to pattern?:	<b>YES</b> <input type="radio"/>	<b>NO (butt joined)</b> <input type="radio"/>		
<b>If YES complete table below</b>				
	<b>Lap Number</b>	<b>Lap size</b>	<b>Notch Angle</b>	
	<b>Lap 1:</b>			
	<b>Lap 2:</b>			
	<b>Lap 3:</b>			
	<b>Lap 4:</b>			
If corners are notched (as shown above) complete Notch Angle column. For example, No notch = 0 or blank, as shown = 90				

<b>Other Settings</b>	
Number of press lines	Number divisible by 4 (default = 24)

**ALL information in this document must be completed to produce a pattern.**

For further information contact details are at [www.plate-n-sheet.com.au](http://www.plate-n-sheet.com.au).