

Client Name:		Contact Phone:
Date:	This item ID:	References PO No:
Authorised by:		Signature::
Purchase order to show quantities and date required. PO to reference This Item ID		

<h3>Transition - Ellipse To Ellipse - Offset</h3> <p>A Transition between two ellipses. The top and base are parallel and the top may be offset from the center line.</p>	
---	---

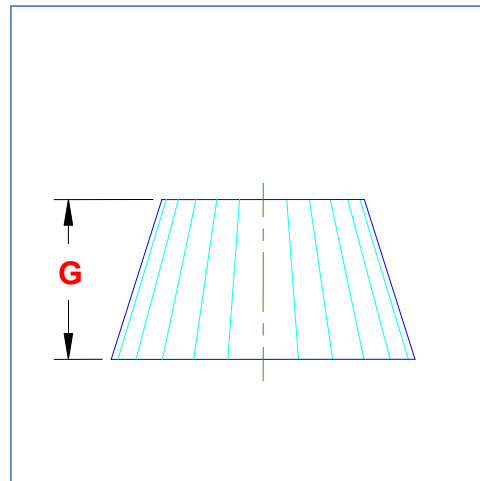
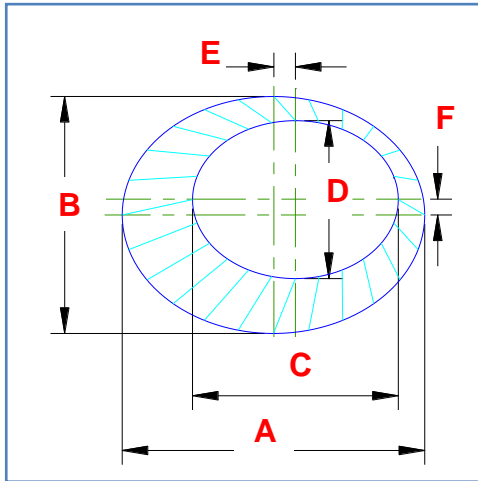

Dimension	Description	Your dimension
A	Base Axis X	
B	Base Axis Y	
C	Top Axis X	
D	Top Axis Y	
E	Offset X	
F	Offset Y	
G	Height	

Units of measure (mm, m, inch, etc):			
My dimensions are measured at the (tick one) :	Inside	Mean	Outside
	<input type="checkbox"/>	<input type="checkbox"/>	<input type="checkbox"/>
Material Type:		Material Thickness:	

ALL information in this document must be completed to produce a pattern.

For further information contact details are at www.plate-n-sheet.com.au.

Client Name:		Contact Phone:
Date:	This item ID:	References PO No:
Authorised by:		Signature::
Purchase order to show quantities and date required. PO to reference This Item ID		

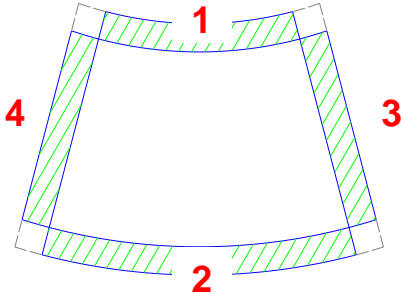
Lap Details				
Are overlap allowances to be added to pattern?:		YES <input type="radio"/>	NO (butt joined) <input type="radio"/>	
If YES complete table below				
	Lap Number	Lap size	Notch Angle	
	Lap 1			
	Lap 2:			
	Lap 3:			
	Lap 4:			
If corners are notched (as shown above) complete Notch Angle column. For example, No notch = 0 or blank, as shown = 90				
Other Settings				
Number of press lines			Number divisible by 4 (default = 24)	

ALL information in this document must be completed to produce a pattern.

For further information contact details are at www.plate-n-sheet.com.au.